



Whitestown Welcomes You





Location & Overview

Whitestown, Indiana is conveniently located right off I-65 and just a short, 20-minute drive from both downtown Indianapolis and the Indianapolis International Airport. Our location makes us a perfect place to live and do business just outside of the 15th largest city in the United States.



The trail has an important link to American history, as both the Lincoln Inaugural Train and the Lincoln Funeral

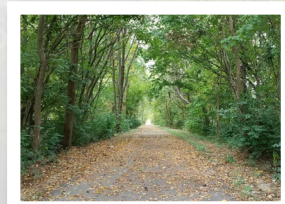

Train traveled that exact route through

Whitestown in 1861 and 1865. According to historians, a hundred mourners gathered around a single bonfire in the new town to pay their respects as the Lincoln Funeral Train passed through at 1:07 am on May 1, 1865.

History & Today

Whitestown was named in honor of Albert S. White (1803-1864). White was a United States Senator from Indiana and a leader in the movement to abolish slavery in the United States. He served in the national House of Representatives from 1837 to 1839, and in the United States Senate from 1839 to 1845.

From our humble beginnings, Whitestown has boomed into a flourishing community that boasted a growth rate of 25.4% in 2014 alone, earning the title of fastest growing community in the state of Indiana for the 6th year in a row.



Mr. White was also the president of the railroad built through Whitestown.

Today, the Big Four Trail celebrates our rich past while repurposing that former historic rail line into a walking/biking path for our residents.

Whitestown was also recently ranked 7th "Best Place to Purchase a Home" in the entire country by the National Association of Realtors, so you made a smart choice!

Thanks for growing with us!

Fastest growing community in the state of Indiana 6 years in a row

U.S. Census Bureau





Education

Whitestown is served by two of the best public school districts in the state. Zionsville Community Schools and the Lebanon Community School Corporation both recently ranked in the top 25 statewide. Traders Point Christian Academy and Boone Prairie School are options for families choosing a private education in Whitestown.

Housing

We have a wide variety of housing options to make Whitestown feel like home whatever your age or income level. From trendy apartment or condo living for our young professionals in places like The Blvd at Anson and The Villas by Watermark to brand new neighborhoods like Westwood Landing, Edmonds Creek, Walker Farms, Eagles Nest, Clark Meadows, and Harvest Park. We also have single-level ranch condominiums for those looking to simplify and brand new senior living communities currently under construction. If you're looking

for more room or a historic feel, consider looking at the homes and properties in our Legacy Core area. You'll soon see why Whitestown was recently named 7th on the list of



Served by two of the best school systems in the state

Indiana Department of Education rankings





Retail

Retail is booming here in Whitestown as companies move in to serve the growing number of residents. Since Meijer opened in 2014, dozens of new restaurants and retail shops have come to Town, with many more on the way.

And much more is brewing in our historic Legacy Core district with the addition of our first local brewery, Moontown Brewing Company, located in the former Whitestown High School. We're also excited to announce the new \$50M retail complex known as the "Shoppes at Whitestown."



***Ranked 7th best place in the country
to buy a home***

National Association of Realtors (2015)





Arts & Leisure

- Golf Club of Indiana
- Hickory Hall Polo Club, the only polo club in the state

Parks & Recreation

- Panther Park
- Walker Park & Trails
- Big Four Trail – brand new 2.0-mile walking/ biking trail through Whitestown (from Zionsville to Lebanon) along our town's historic rail line. The Big Four Trail will eventually be a 50-mile trail linking Zionsville to Lafayette.



Community Events

Whitestown is proud to host several popular annual events designed to cater to our families and our adults. They include:

- Easter Egg Hunt
- 4th of July Fireworks Show
- Free Summer Movie Nights (May – September)
- National Night Out (1st Tuesday in August)
- Whitestown Brew Fest
- Halloween 5K & Trick or Treating Event
- Evening with Santa

We've also started a new Community Gardens and Farmers Market to help our residents eat fresh and eat local!



***Third best suburb to raise a family
in Indianapolis metro***

Niche (2015)





Health Care

Witham Health Services at Anson offers 24/7 emergency medical services, imaging, lab, a walk-in clinic for convenient care, and friendly family-practice physicians – all close to home. Find a physician for your family in a wide variety of medical specialties.

Quick Reference Numbers for Witham Health Services at Anson

Convenient Care (Walk-In Care): (317) 768-2200

Family Medicine: (317) 768-2200

Full Service Emergency Room: (317) 768-2100

General Surgery: (317) 768-2210

Imaging Services: (317) 768-2120

Lab Services: (317) 768-2110

Creekside OB/GYN: (317) 768-2230

Orthopaedics: (317) 768-2240

Pediatrics: (317) 768-2222

Physician Specialty Center: (317) 768-2250

Business & Industrial

We have plenty of room for you to grow your business! From small retail sites to larger corporate sites, our planning department is ready to make your move to Whitestown as easy as possible.



Quality care, close to home





AllPoints at Anson:

The 600-acre industrial park known as AllPoints at Anson has nearly a dozen buildings. Tenants include: Amazon.com, Daimler, REGO-FIX, AmerisourceBergen, Facility Concepts Inc., Brooks Sports, Express Scripts, Weaver Popcorn Co., Kenco, and General Nutrition Corp. Browning Investments and Duke Realty Corporation, two of the Midwest's leading commercial real estate companies, have joined forces to shape the future of distribution, logistics, and build-to-suit development in this highly sought-after area of Central Indiana.

This powerful partnership serves as a single source for developing, financing, constructing, owning, leasing, and managing distribution and logistics facilities.

AllPoints at Anson will eventually offer 20 buildings totaling 8.1 million square feet.

Duke Realty is currently constructing several building pads there so that, when a company is interested in the property, their project can start immediately.



Perry Industrial Park:

Perry Industrial Park is a 450-acre, highly visible, master-planned industrial development with sites ranging from three to 30-acres. Perry is located off I-65 at the State Road 267 interchange at exit 133. Perry is 20-minutes from downtown Indianapolis and the Indianapolis International Airport.

Prime lots are currently available for sale or lease, including many with interstate-front exposure for your company.

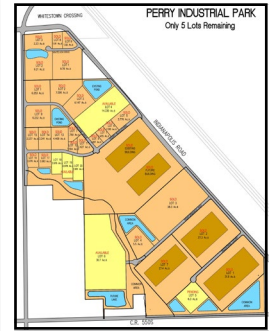

Whitestown Crossing:

Whitestown Crossing is a third area ready for commercial and industrial development. Located on the northwest side of town, it is also along highly visible Interstate 65.





Town Limits

Whitestown has grown so much in the past few years that the post office hasn't quite caught up. Although the postal addresses of some of our newest businesses say Zionsville, they are indeed in Whitestown. If you dealt with the Town of Whitestown for your permits or your utilities, then you are in the Whitestown town limits. See a map of our Town Limits [here](#).

Government

Whitestown strives to be the most transparent and proactive local government in the state of Indiana. All of our Town Council Meeting documents are made public and published online at our website: www.whitestown.in.gov. Our Town Council meetings are held the second Tuesday of each month at the Whitestown Municipal Center. And in an effort to teach young people about local government, we have recently started a new Youth Council. We'd love for you to get involved!

Town Services

Utilities (Department of Public Works)

Whitestown is one of the only communities in the state with all new infrastructure in place to accommodate our growth for decades to come. A brand new water tower came online in May of 2015 which will ensure adequate water pressure for our residents' comfort and for any fire suppression needs. A state of the art waste water treatment plant, also new in 2015, is also designed to meet the needs of growing Whitestown for decades to come. To sign up for water or sewer service, contact Whitestown Municipal Utilities: (317) 733-8584.

Trash Collection/Recycling Services

Ray's: (317) 539-2024

Republic Trash Services: (317) 917-7300

Electric

Boone REMC: (800) 897-7362

Duke Energy: (800) 521-2232

Natural Gas

Vectren: (800) 227-1376

Phone, Cable, Internet

Bright House: (317) 972-9700

Comcast: (317) 653-5951

TDS: (866) 571-6662





Planning

We're planning wisely for Whitestown's continued rapid growth over the next five, 10, and 20 years. See our newly revised 2015 Comprehensive Plan [here](#).

For permits or questions about planning, contact our Planning Department at planning@whitestown.in.gov.

Public Safety

We take great pride in the safety of our community. Our police officers and firefighters are some of the only in the state to be cross-trained to better serve you during whatever emergency you may encounter.

Our new bicycle patrols are in your neighborhoods.

Our police department also offers free, extra patrols of your home while you're on vacation to give you peace of mind when you're away. Sign up is quick and easy online at:

www.whitestownpolice.org



If you really want to get an idea of what it's like to be a Whitestown Public Safety Officer, sign up to take part in our brand new Public Safety Cadet Program!





If you're interested in our Adopt-a-Road program contact:

Tanya Sumner

Director of Public Relations

Direct Line: (317) 732-4536

Email: tsumner@whitestown.in.gov

We're always here to help!

Visit our website at www.whitestown.in.gov

Find your Town Councillor [here](#).



Town of Whitestown
6210 Veterans Drive Phone: (317) 769-6557
Whitestown, IN 46075 Fax: (317) 769-0906



Like us on Facebook



Follow us on Twitter



Watch us on YouTube

#WhitestownProud

2016-2





WHITESTOWN
INDIANA